

Recommended PCB Layout

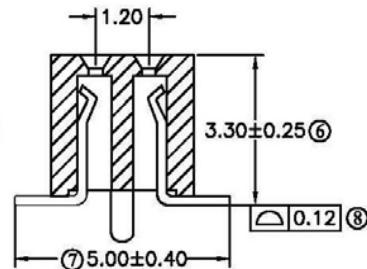

SPECIFICATIONS

Current Rating: 1AMP
 Contact Resistance: 20Mohm Max
 Insulation Resistance: 5000Megohms Min
 Withstand Voltage: 500V AC/minute
 Operation Temperature: -40°C to $+105^{\circ}\text{C}$

Contact: Phosphor Bronze
 plating: Au or Sn Over 50u" Ni
 Insulator: High Temperature Thermoplastic
 UL94V-0 Rated
 Standard: PA6T+30%G. F

凱帛企業有限公司

KABO ENTERPRISE CO.,LTD.

Name

Pitch:0.8mm Female Header SMT V/T TYPE

Drawing No.

FH-0.8-1006-xx01N

DR

CHK

APPD

General Tolerances :

x.xx \pm 0.20
x.x \pm 0.30

Unit :

mm

Scale :

ROM