

序号	品名	材质
①	1.0- E型卧式WTB胶芯	LCP UL94V
②	1.0- E型卧式WTB端子	磷青铜/表面镀锡
③	1.0- E型卧式WTB焊片	黄铜/表面镀锡

CKT	DIM A	DIM B	DIM C
2	1.00	2.50	4.00
3	2.00	3.50	5.00
4	3.00	4.50	6.00
5	4.00	5.50	7.00
6	5.00	6.50	8.00
7	6.00	7.50	9.00
8	7.00	8.50	10.00
9	8.00	9.50	11.00
10	9.00	10.50	12.00
11	10.00	11.50	13.00
12	11.00	12.50	14.00
13	12.00	13.50	15.00
14	13.00	14.50	16.00
15	14.00	15.50	17.00
16	15.00	16.50	18.00
17	16.00	17.50	19.00
18	17.00	18.50	20.00
19	18.00	19.50	21.00
20	19.00	20.50	22.00
22	21.00	22.50	24.00
24	23.00	24.50	26.00
26	25.00	26.50	28.00

開模PIN:2/3/4/5/6/7/8/9
/10/11/12/13/14/15/16

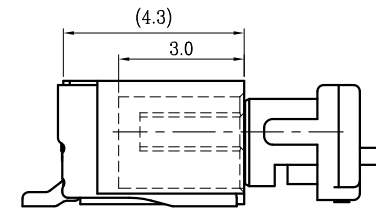
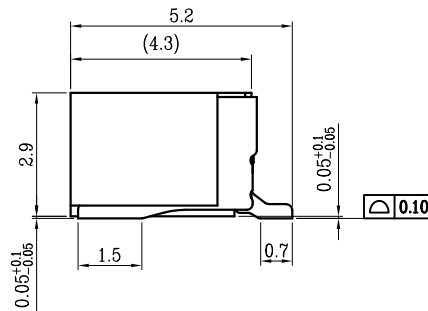
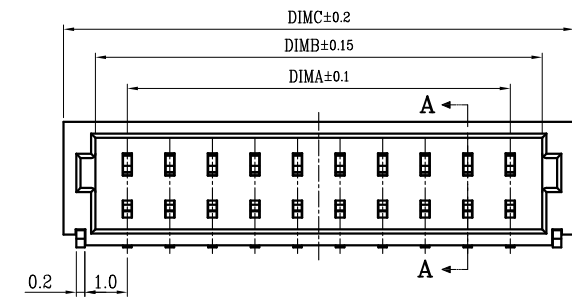
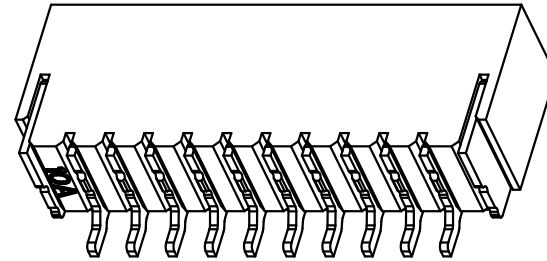
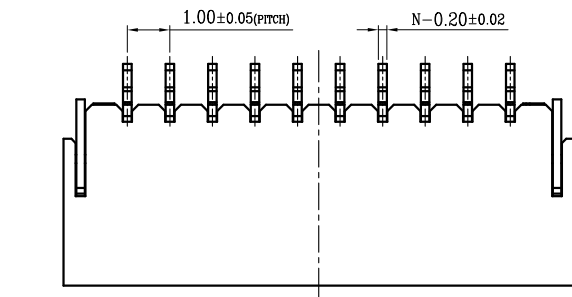

MATED CONDITION

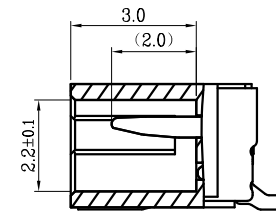
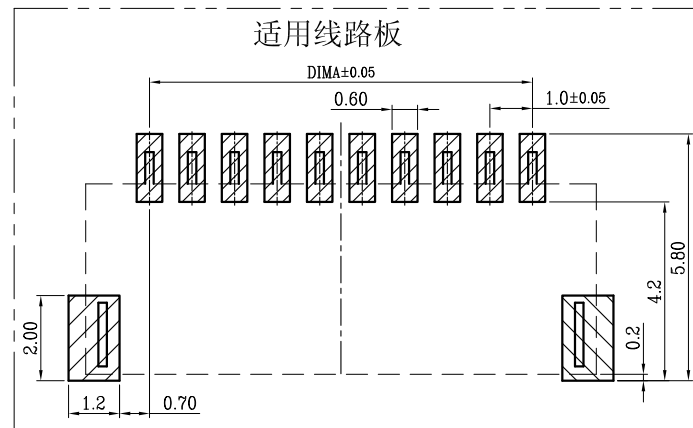
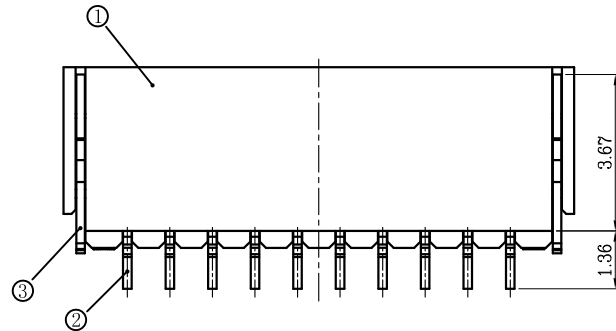

SECTION A-A

技术指标:

1. 塑件表面应光洁、无毛边、无明显收缩、缺陷、裂纹等现象。
2. 温度范围: -25° C~85° C.
3. 额定电压: 30V, AC/DC.
4. 接触电阻: ≤0.02Ω.
5. 绝缘电阻: ≥100MΩ.
6. 额定电流:

适用电线型号: a. AWG#28:1.0A(per pin)
b. AWG#30:1.0A(per pin)
c. AWG#32:0.8A(per pin)

凱帛企業有限公司 KABOE ENTERPRISE CO.,LTD.		
Name Pitch:1.0mm Wafer SMT R/A (單排) 無鹵 黑膠		
Drawing No. WF-1.0-1028-xx93R		
APPD	-HK-	D-R
General Tolerances : X ±.50 XX ±.10 Y ±.20 XXX ±.05 ANGLES ±1°	Unit : mm	Scale : ROM