

额定电流 Current rating: 1.0A
 额定电压 Voltage rating: 50V
 耐电压 Withstand coltage: 500V AC/minute
 接触电阻 Contact resistance : $\leq 30m\Omega$ Max
 绝缘电阻 Insulation resistance: 100M Ω Min
 工作温度 Working temperature: $-25^{\circ}c \sim +85^{\circ}c$

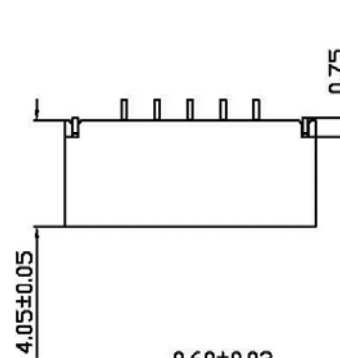

磷銅 C5191-H T=0.20mm.	鍍錫
PA9T UL94V-0 本色.	UL 94V-0 本色.
材料规格	电镀方式/颜色

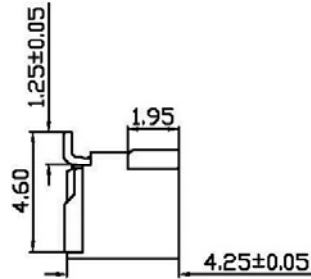
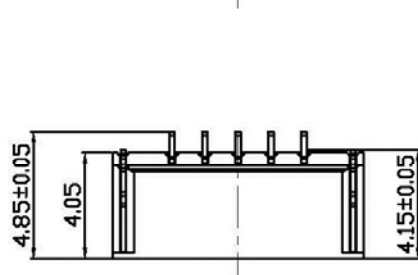
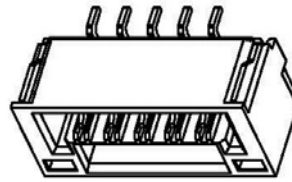
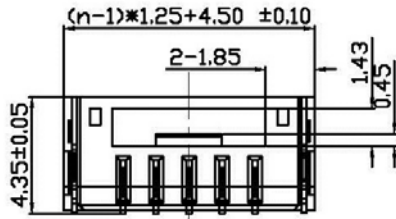
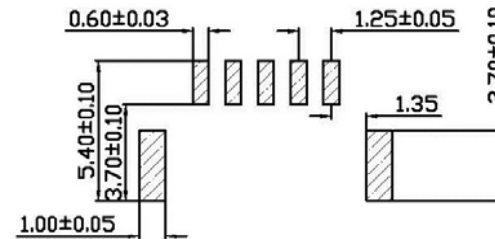
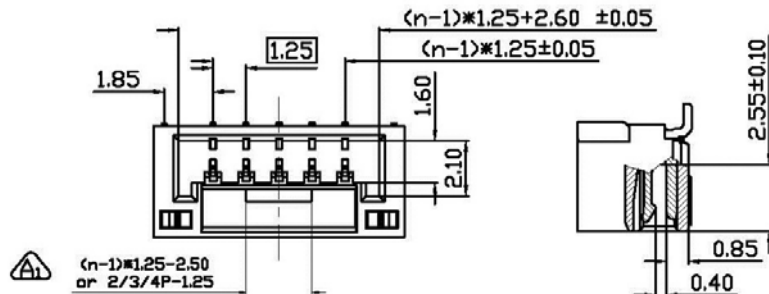

PCB 寸法
PCB Layout

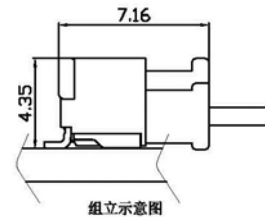

凱帛企業有限公司 KABOE ENTERPRISE CO.,LTD.		
Name Pitch:1.25mm Wafer SMT R/A TYPE (無耳)		
Drawing No. WF-1.25-1042-xx93N		
APPD	-HK-	D-R
General Tolerances : -x.xx± x.x±	Unit : mm	Scale : ROM